

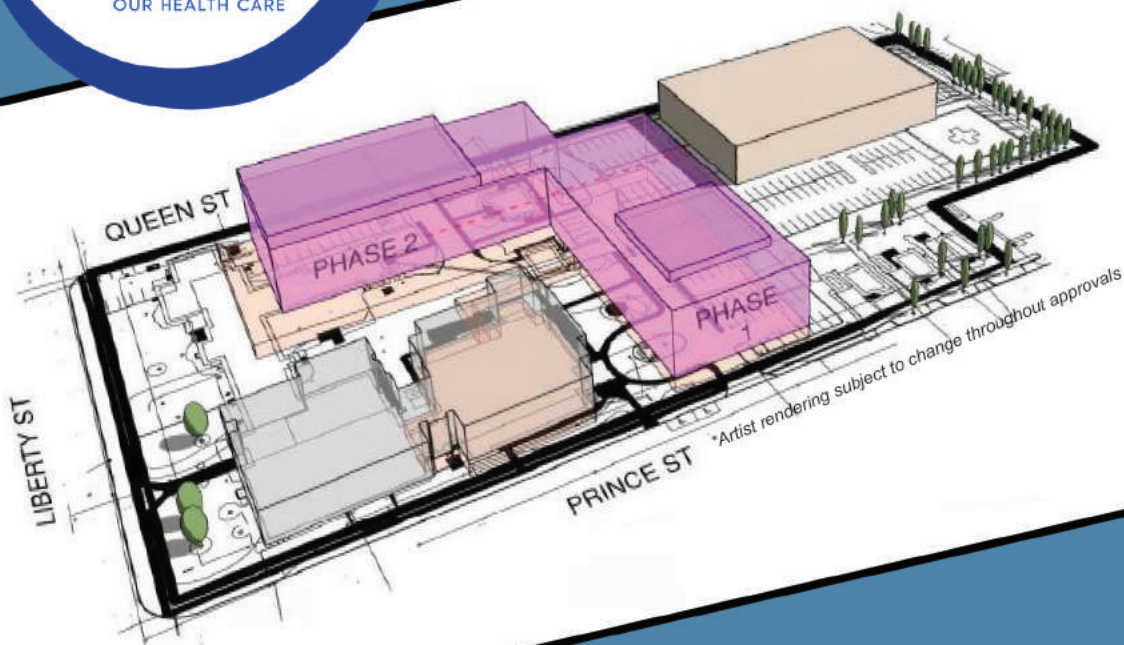

INVESTING IN
OUR HEALTH CARE



BOWMANVILLE HOSPITAL REDEVELOPMENT & EXPANSION PROJECT

BOWMANVILLE HOSPITAL FOUNDATION



The Bowmanville Hospital Foundation is the heart of the Clarington community. For the past 45 years, the Foundation has been the fundraising arm for Bowmanville Hospital, inspiring the community to help support capital improvements and essential medical equipment needs for Bowmanville Hospital.

The Foundation is governed by a volunteer Board of Directors and is managed by a dedicated staff of professionals who ensure that your gift is used effectively and efficiently right here at Bowmanville Hospital.



MISSION

To inspire the human potential to give, one giver, one gift at a time.



VISION

A circle of giving, caring and sharing. Working together to make a difference in the health of our community.



VALUES

We are committed to leadership, accountability, teamwork and integrity.





Lakeridge Health is one of Ontario's largest community hospitals, serving people across Durham Region and beyond. Lakeridge Health is a network of five hospitals with four foundations serving: Ajax Pickering Hospital; Bowmanville Hospital, Oshawa/Whitby Hospital; and Port Perry Hospital.

With five hospital sites and four Emergency Rooms, we serve a diverse population. Comprised of more than 4,900 doctors, nurses and other health care professionals and over 1,500 volunteers, Lakeridge Health is developing a reputation as a quality leader and innovator.

BOWMANVILLE HOSPITAL

Bowmanville Hospital is home to our Regional Eye Centre and is a full-service community hospital that provides safe quality care to residents who live in the Municipality of Clarington.

Services include: Emergency and Critical Care, In-Patient and Out-Patient Surgery, Complex Continuing Care, Diabetes Education Program, In-Patient and Out-Patient Rehabilitation Services, Palliative Care, Diagnostic Imaging and Laboratory Services.



THE PROJECT

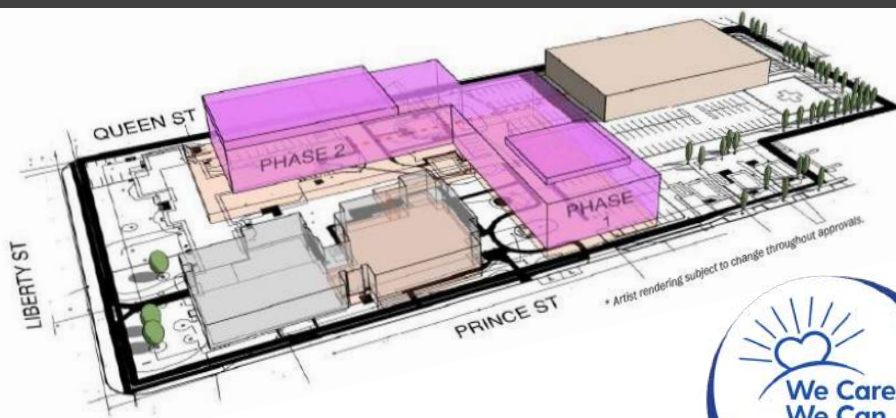

WHAT THIS MEANS FOR YOU

- Improved health outcomes and cost optimization
- Improved patient experience and care while optimizing efficiencies
- More coordinated care for patients
- Patients have a more positive experience of health care
- Patients can get back home sooner
- Improving efficiencies at which we deliver care will enable Lakeridge Health to do more with our health care dollars
- Most importantly, ensures families are as healthy as possible throughout their lives



“The limitations of a hospital’s facility have a significant effect on its ability to enhance capacity. It’s not simply about increasing space or adding services to improve the quality of care – it’s about every detail in the hospital, right down to the smallest ancillary service departments that make efficient care possible.”

Chris Kooy

Former Vice-President, Clinical Programs & Chief Nursing Executive;
Chair, Board of Directors, Bowmanville Hospital Foundation





BOWMANVILLE HOSPITAL: BY THE NUMBERS

With no major upgrades to our facilities in the past 30 years, Bowmanville Hospital as currently constructed will be unable to handle the increased demand for services in the years ahead.



Durham Region is one of the **fastest growing populations** in the province



Bowmanville Hospital serves a local population of more than **98,000**



The ER was built to accommodate 18,000 visits annually. Today, it serves more than **35,000** emergency visits, nearly **41,000** diagnostic visits and more than **11,000** surgical cases*



Redevelopment project will **double the size** of Bowmanville Hospital

*As per 2016 data.

Between 2005 and 2015, Durham Region grew by 15%, more than 5% higher than the Ontario-wide average. By 2031, nearly one million people will call it home.*

As Durham Region continues its rapid growth, it is critical that the capacity of our health care systems continue to grow to manage increased demand while providing the highest quality of care.

The project plays a direct role in attracting the most qualified medical professionals to Lakeridge Health and encouraging them to embrace Clarington as their community.

*All population and demographic data provided by Durham Region Planning and Economic Department, "Demographics and Socio-Economic Data," October 2015.

PROGRAMS & SERVICES IMPACTED

How Our Enhanced Facility Will REDEFINE HEALTH CARE IN CLARINGTON

- Expansion will support our ability to double the number of patients served annually
- Drastically reduce the amount of time spent in hospital (through a focus on outpatient services and improved efficiencies that reduce wait times)
- Create a seamless health care experience across the Lakeridge Health network – make it easy to get the care you need at Bowmanville Hospital or any other site



- Focus on offering the services of greatest need and value to Clarington residents

BOWMANVILLE HOSPITAL - FACILITY PRIORITIES



New Emergency Department (ED)

- Major expansion will double the size of the current ED
- Address increasing pressure on the ED
- Provide more treatment spaces
- Reduce wait times and improve efficiencies



New/Upgraded Surgical Suites

- Larger spaces and new technology offering 21st-century care
- Equip suites with the most advanced surgical technology
- Increase number of surgical suites from 2 to 4*



Medical & In-Patient Units

- Highest level of care and seamless patient experience
- Suitably sized In-Patient rooms
- Private patient rooms with their own bathrooms
- Lighter/brighter spaces with wider hallways and doorways
- Increase number of beds from 78 to 179*



New Laboratory & Pharmacy Spaces

- Improve efficiency and convenience for Bowmanville Hospital patients
- Smoother workflow resulting in quicker turnaround time



Contemporary Hospital Design

With flexibility to grow alongside Clarington:

- Private patient rooms
- Larger, multi-purpose surgical spaces
- Large, suitably placed support services

*Subject to change throughout approval process



**Lakeridge
Health**

PROGRAMS & SERVICES IMPACTED



A growing population in Clarington will place unique needs on health care infrastructure. For example, seniors are more likely to experience conditions that require more complex medical attention from a range of specialized services, as well as longer stays in hospital.

For other patients, the need for personalized care is replaced by the daily reality of ensuring that they can manage chronic conditions or illnesses with access to timely, hassle-free care delivered where it may be accessed easily whenever possible.

SERVING THE COMMUNITY AS A WHOLE

To prepare for rising demand related to our growing population, the new redevelopment at Bowmanville Hospital will include a significant increase in In-Patient facilities and beds to expand the number of patients we serve close to home.

“This is what community health care is all about. It’s absolutely necessary that Bowmanville Hospital is provided with the resources to serve everyone in our community.”

Kirk Kemp
Campaign Chair



WHERE WE ARE

Overview of Capital Planning Process

Since the January 26 announcement, Lakeridge Health has been diligently working with the Ministry to move the plans forward. The capital planning process is broken down into five stages.

Planning Grants

3 possible approval milestones: proposal development, functional program, design development



Fundraising will be Managed Simultaneously Throughout the Planning Process

ANTICIPATED TIMELINES*

MASTER PLAN	I.O. TIMELINES
<ul style="list-style-type: none"> Stage 1 (Proposal Planning) submitted May 2019 Stage 2 work commence Fall 2019 Construction timelines: 4-5 years Material expansion ~100 in-patient beds 	<ul style="list-style-type: none"> Infrastructure Ontario (I.O.) Timelines: <ul style="list-style-type: none"> Request for Qualifications: Summer 2020 Request for Proposals: Winter 2021 Financial Close: 2022

*All timelines contingent on receiving Ministry of Health approvals.



WHERE WE ARE

In September 2019, Infrastructure Ontario identified the Bowmanville Hospital redevelopment and expansion as a near-term priority project on the Fall 2019 Ontario P3 Market Update.

Infrastructure Ontario, a crown agency overseen by the Minister of Infrastructure, is responsible for delivering projects under Ontario's P3 model.

The public-private partnership (P3) model is used to make historic infrastructure investments in civil, health care and community safety across the province, that will benefit the people of Ontario now and for many years to come.

Ontario's P3 model is an innovative way of financing and procuring large public infrastructure projects. It makes the best use of private-sector resources and expertise to provide on-time, on-budget and to-specification project delivery.

Infrastructure Ontario
P3 Market Update - Fall 2019
Projects in Pre-Procurement

Project Name	Location	Value (\$M)	Start Date	End Date	Procurement Method	Notes
Bowmanville Hospital Redevelopment and Expansion	Bowmanville	150	2020	2025	P3	Redevelopment and expansion of Bowmanville Hospital
Other projects listed in the table						



“The announcement of the funding for the revitalization of Bowmanville Hospital is a major step for health care here in Durham Region. Now, it’s important that we come together as a health network and a community to realize this important opportunity.”

Sharon Cochran, Chair, Lakeridge Health Board of Trustees

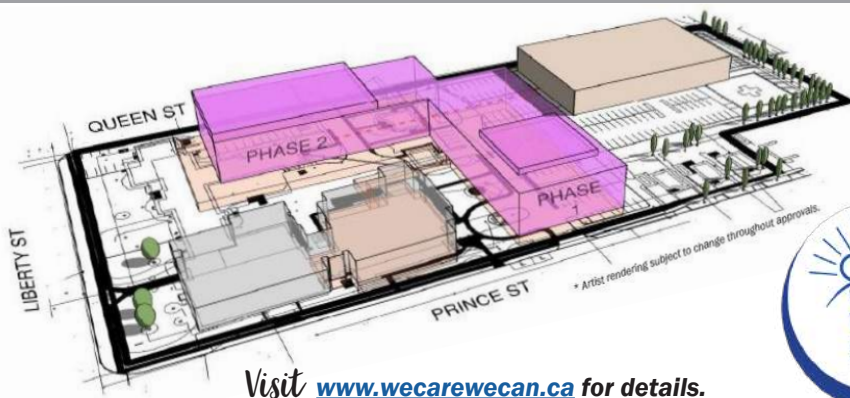

Visit www.wecarewecan.ca for details.



OUR SUPPORTERS



The We Care, We Can Campaign is off to an incredible start in support of the redevelopment and expansion project for Bowmanville Hospital.

The Bowmanville Hospital Foundation is fortunate to have such generous and giving donors living right here in Clarington. From small businesses and individuals to family foundations, service organizations and large corporations, we all share the same goal: accessible health care close to home.

MAJOR GIFTS SECURED TO DATE



\$5-million
Municipality of Clarington

“It is an exciting time of growth and transformation in Durham. The new facility for Bowmanville Hospital is a critical investment for the entire region. Every gift to our Foundation is meaningful; large or small every gift counts.”

Frank Cerisano
CEO, Bowmanville
Hospital Foundation



MAJOR GIFTS SECURED TO DATE



\$2-million-and-one
Halminen Family Foundation
& Lakeside Self-Storage



\$2-million
Kemp Family



\$1-million
Association of Hospital
Volunteers - Bowmanville



\$500,000
The Edmond & Sylvia
Vanhaverbeke Foundation



\$250,000
St. Marys Cement /
Votorantim Cimentos



\$100,000
Hennessey Family

DONOR RECOGNITION



DONOR WALL

It is with gratitude that we honour the generous contributions of our donors in the public spaces within Bowmanville Hospital (with the exception of those who wish to remain anonymous).

Our donor walls are just one of the ways we say thank you for your pledged, one-time or cumulative giving and encourage others to follow in your footsteps.

Recognition Levels

VISIONARY \$1,000,000 +

PARTNER \$500,000-\$999,999

ASSOCIATE \$250,000-\$499,999

PATRON \$100,000-\$249,999

AFFILIATE \$25,000-\$99,999

COLLEAGUE \$10,000-\$24,999

COMPANION \$5,000-\$9,999

FRIEND \$2,500-\$4,999

TEAMMATE \$1,000-\$2,499

DONOR RECOGNITION



The Bowmanville Hospital Foundation offers naming opportunities during capital campaigns. Generally, capital gifts may be considered for a naming opportunity at the \$25,000 level or higher; however, naming opportunities remain specific to each campaign and require approval from the Board of Directors and Lakeridge Health.

LAKERIDGE HEALTH RECOGNITION & NAMING POLICY

Category	Gift Amount	Recognition
Transformational	\$15M+	Negotiated Recognition
Larger, static areas/assets:	\$10M to below \$15M	Tower or Wing
	\$5M to below \$10M	Floor
	\$1M to below \$5M	Service/Partial Floor
Functional Areas/Other Smaller Areas	\$500K to below \$1M	High Traffic Areas (i.e., nursing station)
	\$250K to below \$500K	Suites (i.e., birthing suite)
	\$100K to below \$250K	Common Area/ Waiting Rooms
	\$25K to below \$100K	Patient Rooms/ Conference Rooms

BENEFITS TO THE COMMUNITY

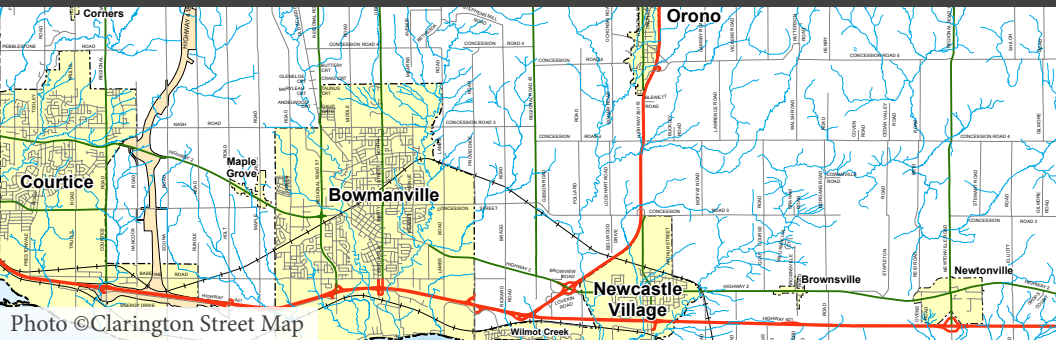

Photo ©Clarington Street Map

The people of Clarington and Durham Region have long been proud of our community's beauty, small-town charm, economic property and high quality of life.

Fueled by new residents, economic growth and investments in transportation infrastructure, the communities that comprise the Municipality of Clarington are among those that will see the greatest transformation in the years to come.



Hospital System as an Anchor Institution

Building long-term prosperity and healthier communities



Hospital System as an Employer

Direct and indirect creation of jobs
(construction and post-construction)

“Corporate investment in this campaign will create a stronger economy that will ultimately come back to businesses in the form of greater economic growth, new partnerships and other opportunities.”



Sheila Hall, Executive Director and Economic Development Officer,
Clarington Board of Trade

BENEFITS TO THE COMMUNITY



Photo ©Clarington Tourism

As both a community hospital and an integral part of the wider Lakeridge Health network, the newly redesigned facility will provide residents with a hospital experience that embodies both the personal attention of a local hospital with an easy and hassle-free transition to the full spectrum of health care services Lakeridge Health offers.

By offering the latest in medical technology and a facility that integrates both a welcoming environment and growing hospital system, we will ensure that Clarington and Durham Region will be home to many of the best physicians in the Greater Toronto Area.



Community Contributor

Hospital system as an entity whose employees contribute greatly to local community



Municipal Benefits

Local income creation for a wide-range of industries

PLEDGE COMMITMENT FORM



Please complete this form and return to:

47 Liberty Street South, Bowmanville, ON L1C 2N4 | Telephone: 905.623.3331 x 21388

Email: bmatovic@lh.ca

PERSONAL INFORMATION

☐ Mr. ☐ Mrs. ☐ Dr. ☐ Mr. & Mrs. ☐ Ms.

First Name: _____ Last Name: _____

Spouse Name: _____

Organization (if applicable): _____

Address: _____

City: _____ Province: _____ Postal Code: _____

Phone (Day): _____

Phone (Alternate): _____ Email: _____

PLEDGE COMMITMENT

☐ I pledge \$ _____ to Bowmanville Hospital Foundation designated to the redevelopment and expansion project for Bowmanville Hospital.

☐ I would like pledge reminders mailed to the address above. Please send reminders beginning on _____ (date).

☐ Annually

☐ Quarterly

Acknowledgement Information

Please use the following name(s) in all acknowledgements: _____

☐ I (we) wish to have our gift remain anonymous.

PLEDGE COMMITMENT FORM



Please complete this form and return to:

47 Liberty Street South, Bowmanville, ON L1C 2N4 | Telephone: 905.623.3331 x 21388
Email: bmatovic@lh.ca

PAYMENT METHOD

Pledge Amount: \$ _____ Annual Pledge Payment: \$ _____

Pledge Begins: _____ (date)

Pledge Period: ☐ 3 years ☐ 5 years ☐ 10 years ☐ Other _____

Preferred Pledge Process Date: _____

Cardholder's Name: _____

Card Type: ☐ VISA ☐ MasterCard ☐ American Express ☐ Cheque

Card Number:

Expiry Date (mmyy): Card Security Code:

Signature: _____ Date: _____

☐ Help reduce cost; send my receipt via email. _____

Thank You!

Charitable Registration No. 11924 4903 RR0001

Privacy Policy:

Bowmanville Hospital Foundation is strongly committed to protecting the privacy and confidentiality of your personal information. We value your trust and recognize that maintaining this trust requires that we be open and accountable in our treatment of the personal information that you choose to share with us. We do not lend, rent or sell your information. Personal information collected by the Foundation is kept in strict confidence.